

REAR WINDOW GUARDS

2018 Expedition MAX Rear Window Guards

937-0357A

Installation Instructions

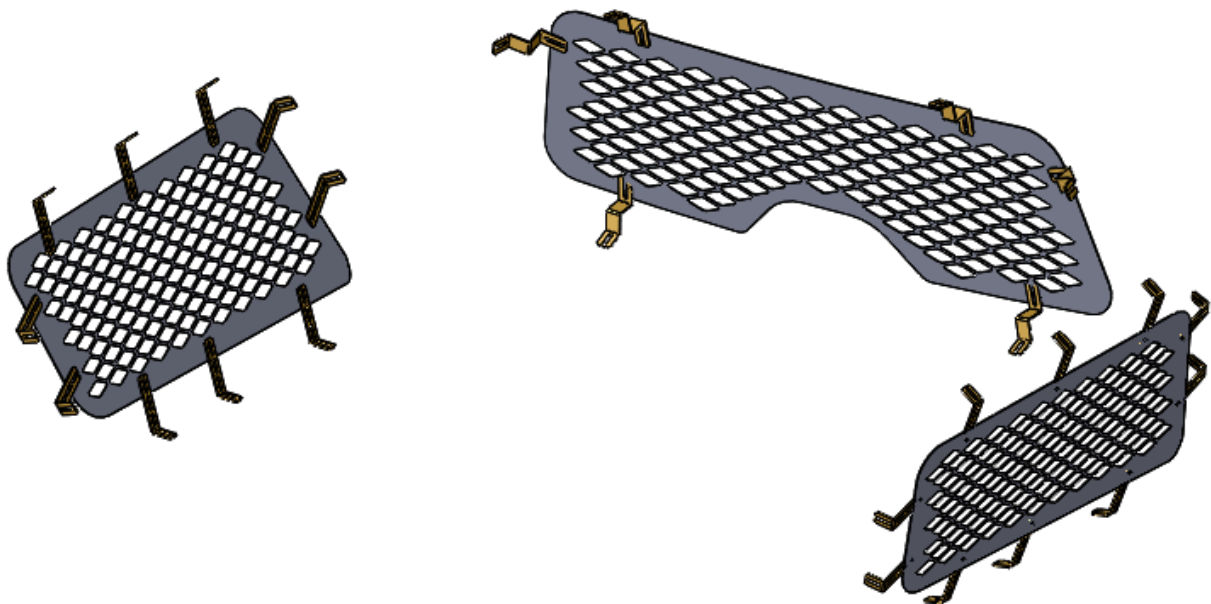

Parts List

Part #	Description	Qty
837-0481A	RS/LS Rear Side Window Guards	2
837-0482A	Rear Hatch Window Guard	1
837-0485A	Side Guard Bottom Mount Bracket	6
837-0486A	Side Guard Top Mount Bracket	6
837-0487A	Side Guard Side Mount Bracket	8
837-0488A	Rear Guard Mount Bracket	6
	10-32 x 5/8" Round Head Bolt	26
	#10 Nyloc Nut	26
	#10 Flat Washer	26
	10-32 x 3/4" Self Tap Screw	26

Installation Instructions

INTERIOR SIDE BACK WINDOW GUARDS

Step 1

- A. Test fit window guard without mounting brackets to ensure proper fitting.
- B. Ensure the larger/rounder corner is pointing to the rear of the vehicle

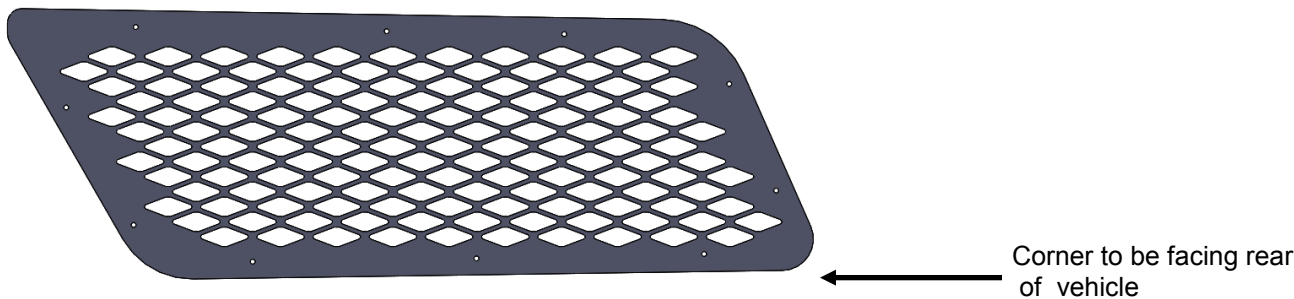

Step 2

- A. Mount 3 bottom mount brackets indicated by straight corners to the side window guard using the 10-32 x 5/8" Bolt, #10 Nyloc Nut and #10 Washer. DO NOT TIGHTEN.

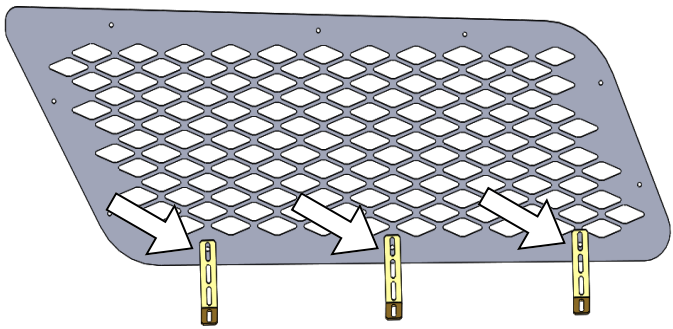
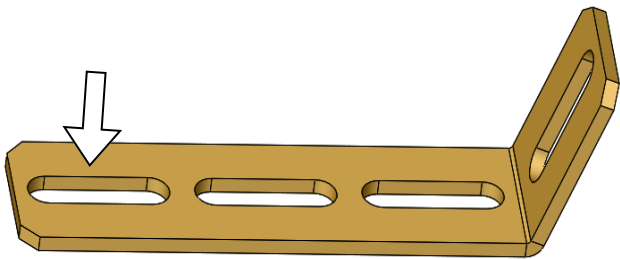

- B. Angle's may need to be slightly altered dependent on fit.

Step 3

- A. Mount 4 side mount brackets indicated by rectangular slots to the side window guard using the 10-32 x 5/8" Bolt, #10 Nyloc Nut and #10 Washer. DO NOT TIGHTEN.

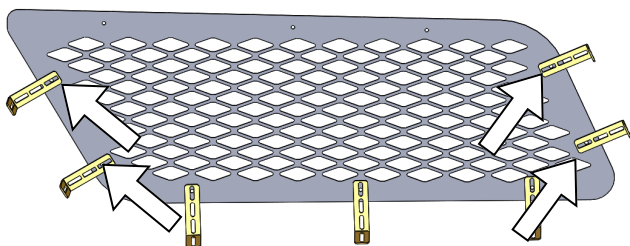
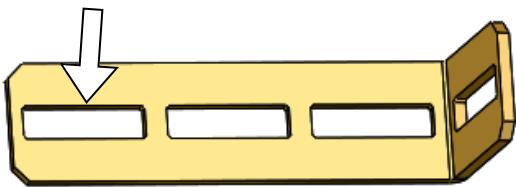

- B. Angle's may need to be slightly altered dependent on fit.

Step 4

- A. Mount 3 top mount brackets indicated by the round corners to the side window guard using the 10-32 x 5/8" Bolt, #10 Nyloc Nut and #10 Washer. DO NOT TIGHTEN.

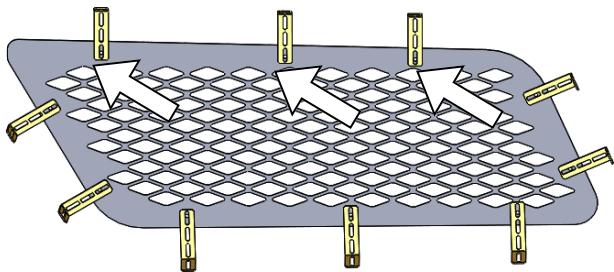
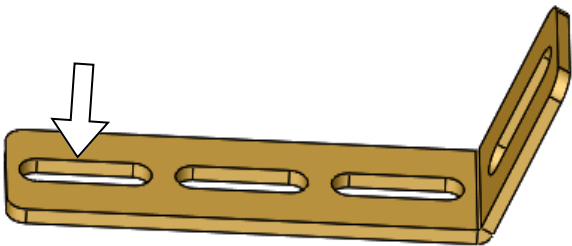

- B. Angle's may need to be slightly altered dependent on fit.

NOTE: EXTRA SLOTS GIVEN FOR HEIGHT ADJUSTMENT WHEN MOUNTING TO VEHICLE. COMPLETE ALL STEPS FOR BOTH RIGHT AND LEFT SIDE WINDOW GUARDS.

Step 5

Remove plastic covers around the cargo window as shown in the below figure, to allow access to the metal frame for direct mounting of the window guards.

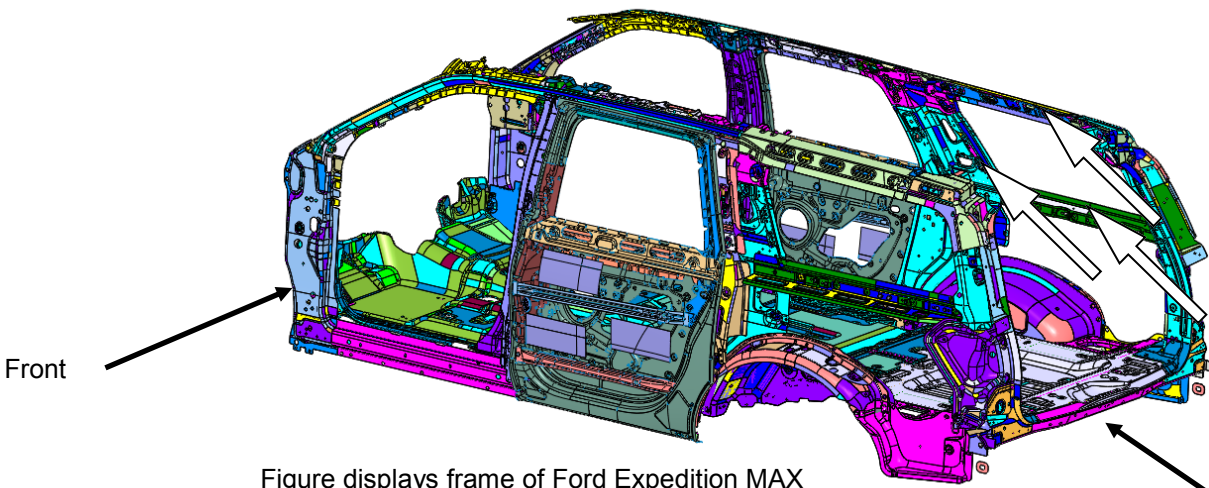

Figure displays frame of Ford Expedition MAX

Arrows showing where plastic needs to be removed and headliner pulled back. Ensure all metal around window is visible for mounting. Must be done to both sides of the Cargo windows.

Step 6

Place the windows guards against the window (not touching) and align the brackets with the metal frame. Ensure the brackets have been placed flush against the metal frame, tighten the brackets to the window guard to ensure proper fitting. At this point, some slight alteration bending may be required on the brackets to acquire a more accurate fit. Mark off mounting locations and pre drill small guide holes for the self tap screws.

Step 7

Re-align the cargo window guard with the pre-drilled holes and use 10-32 x 3/4" Self Tap Screws to mount the guards to the vehicle. Once window guards are in place, put all plastic panels back and cut slots into panels to allow relief for the mounting brackets.

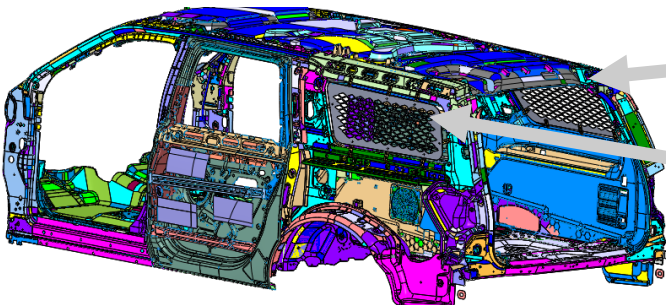

Window guards installed with plastic panels back in original locations



Step 8

- A. Install 5 mount brackets indicated by the multiple bends to the hatch window guard using the 10-32 x 5/8" Bolt, #10 Nyloc Nut and #10 Washer. DO NOT TIGHTEN.
- B. Angle's may need to be slightly altered dependent on fit.

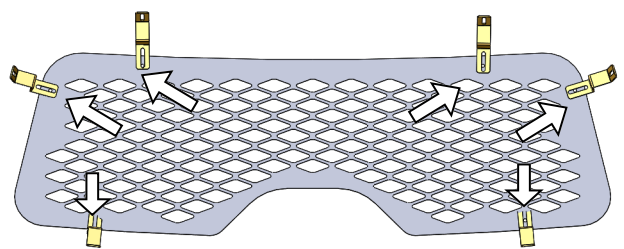
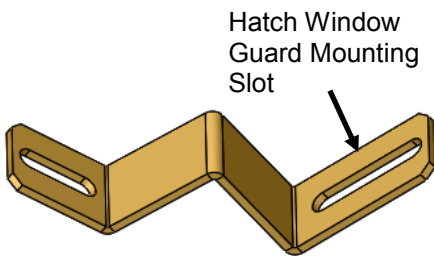

Step 9

Remove rear cargo hatch plastic panel to expose metal trim for mounting.

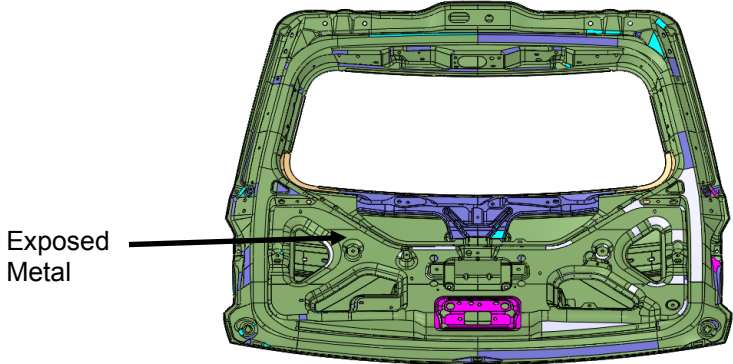
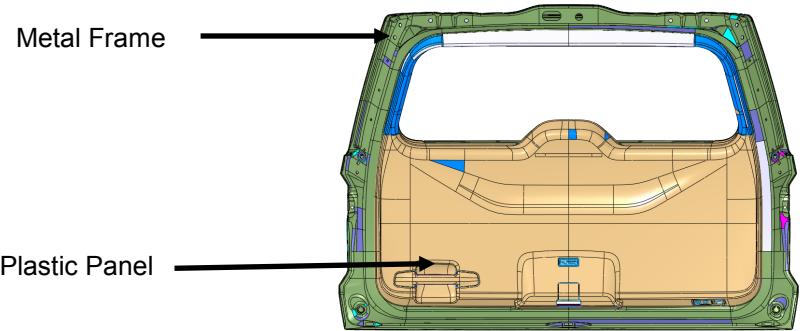

Step 10

Place the hatch window guard against the window (not touching) and align the brackets with the metal frame. Ensure the brackets have been placed flush against the metal frame, tighten the brackets to the window guard to ensure proper fitting. At this point, some slight alteration bending may be required on the brackets to acquire a more accurate fit. Mark off mounting locations and pre drill small guide holes for the self tap screws.

Step 11

Re-align the hatch window guard with the pre-drilled holes and use 10-32 x 3/4" Self Tap Screws to mount the guard to the vehicle. Once hatch window guard is in place, put the plastic panel back and cut slots into the panel to allow relief for the mounting brackets. Installation concluded.

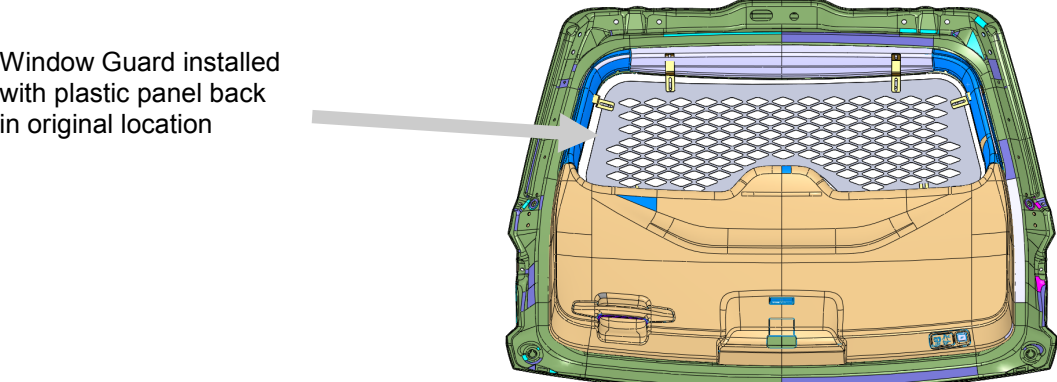

WARRANTY

D & R Electronics warrants its new products to be free from defects in material and workmanship, under normal use and service, for a period of one year on parts replacement, and one year on labor.

This warranty applies only to original purchasers acquiring the product directly from D&R Electronics, or its authorized dealers. Warranty will not be recognized without proof of purchase or bill of sale. This warranty is not transferable.

The warranty begins on the date of delivery to the first user/purchaser. This warranty shall not apply to products which must be repaired due to normal wear and tear, negligence, improper installation, abuse, misuse, or which have been altered or modified at a facility other than D & R Electronics, or its authorized depot center. Units proved to be defective within the warranty period, based on an examination by D&R Electronics, will be replaced or repaired at D & R Electronics' option. This warranty does not cover travel expenses or labor charges for removal or installation.

Lamps, flash tubes, batteries or other items considered consumables are not covered under warranty.

This warranty is in lieu of all other express warranties. D&R Electronics makes no other warranties, expressed or implied, than the express warranties contained herein.

PRODUCT RETURN POLICY

In order to provide you with faster service, product returns for repair or replacement, must have a **Return Goods Authorization Number (RGA number)**. Please contact our company to obtain a RGA number before you return the product to D & R ELECTRONICS. Write the RGA number clearly on the package. Be sure you use sufficient packing materials to avoid damage to the product being returned while in transit.

D & R ELECTRONICS assumes no responsibility or liability for expenses incurred for the removal and/or the installation of products requiring service and/or repair. Repairing or replacing product is at the discretion of D & R ELECTRONICS.

D&R ELECTRONICS Co. LTD.

CANADA

8820 George Bolton Pkwy.
Bolton, Ontario L7E 2Y4

Tel.: (905)951-9997
Fax: (905)951-0019

USA

2321 Kenmore Ave.
Buffalo, NY 14207

Toll Free 1-800-538-7338

www.dandrelectronics.com