

REV.	DESCRIPTION	DCR	BY	DATE	APPROVED

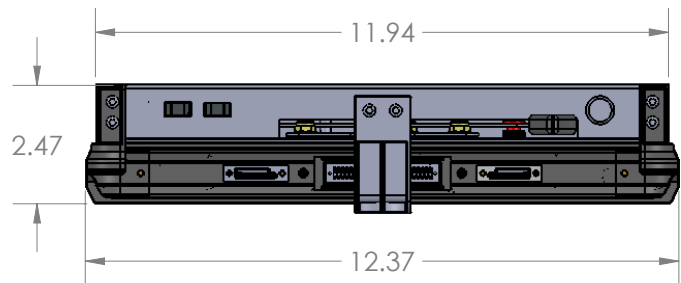

TOP VIEW

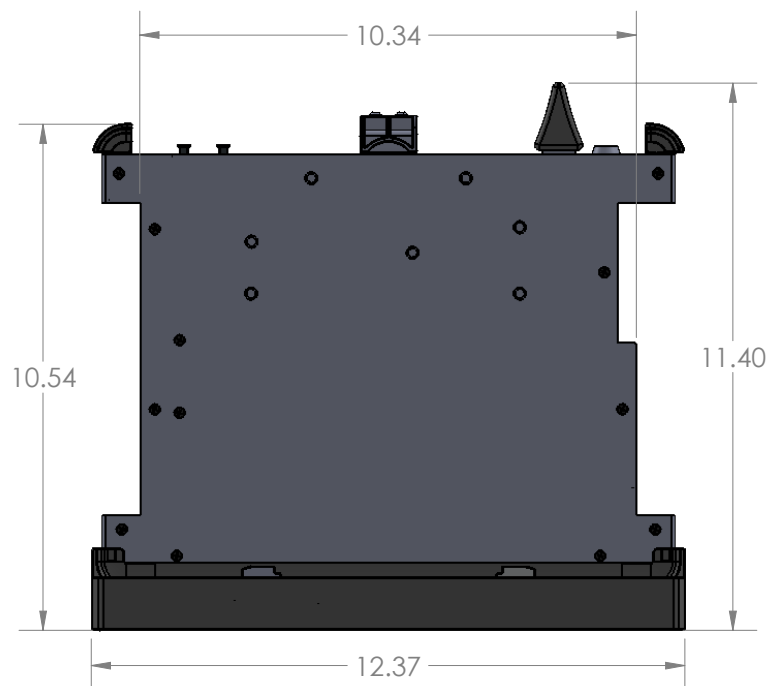

FRONT VIEW

OVERALL DOCK WEIGHT : 3LB  
WITHOUT Dock

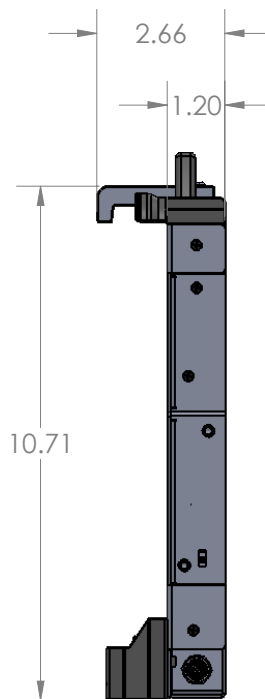

SIDE VIEW

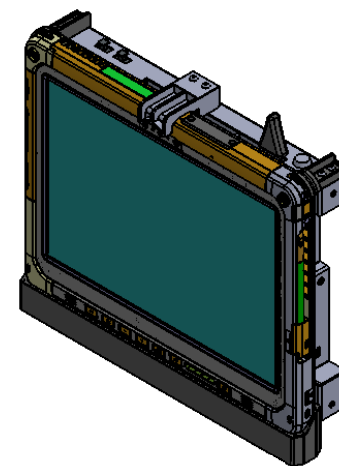

ISOMETRIC VIEW

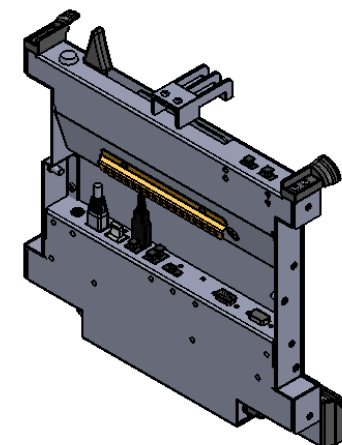

REVERSE ISOMETRIC VIEW

	NAME	DATE	DandR ELECTRONICS CO., LTD.		DANDR-ANSI-A REV2 APRIL 1, 2009	SIZE <b>A</b>
DRAWN	AD	4OCT17	Path: Y:\M\Panasonic cf33 temp\Panasonic CF33 25-09-2017\Panasonic CF 33 29-06-2017\			
CHECKED	AD	4OCT17	File: CF 33 Tablet Dock Date: October-04-17 12:49:31 PM			
THE INFORMATION CONTAINED WITHIN THIS DRAWING IS PROPRIETARY AND CONFIDENTIAL. AND IS THE SOLE PROPERTY OF DandR ELECTRONICS CO. LTD. IT MAY NOT BE REPRODUCED AT WHOLE OR IN PART WITHOUT THE WRITTEN PERMISSION OF DandR ELECTRONICS CO. LTD.			DESCRIPTION:			
			Panasonic CF 33 Tablet Dock			
			MFG. NO. <b>CF 33 Tablet Dock</b>	CATALOG. NO. <b>XXX</b>		
			USED ON: <b>9XX-XXXX</b>	SHEET 1 OF 1		
FINISH	BLACK SEMI-GLOSS		MATERIAL	XXga CRS		REV. <b>0</b>