

Description: Laptop Mount
Model: LT5200

INSTALLATION MANUAL



CONTENTS	
UNPACKING	2
GENERAL DESCRIPTION	2
PART LIST	2
INSTALLATION	3
WARRANTY	4
PRODUCT RETURN POLICY	4

UNPACKING

Before beginning any installation, unpack the equipment received. After unpacking, examine **ALL** components received for any damage that may have occurred while in transit. If any damage has occurred, file a claim **IMMEDIATELY** with the courier stating the extent of damage. Check **ALL** envelopes, packing slips, shipping labels and tags before removing or destroying them.

To ensure your satisfaction, open all cartons and report any shortages **within 48 hours of receipt.**

GENERAL DESCRIPTION

This Laptop Mount height is adjustable up (6 1/2" - 10") and it has an adjustable, ball bearing, detent swivel mount base. It has a built in, quick release sliding tray that extends 6 1/4" in 5/8" increments.

The metalwork is painted with a black epoxy powder coat.

PARTS LIST

Item #	Part #	Description	Qty
4	401-0043	BOLT,1/4-20 x 3/4" CARRIAGE,ZINC	4
4	422-0009	NUT,1/4-20, NYLOC, ZINC	4
4	403-0005	WASHER,1/4 FLAT S.A.E.	4

FIGURE 1

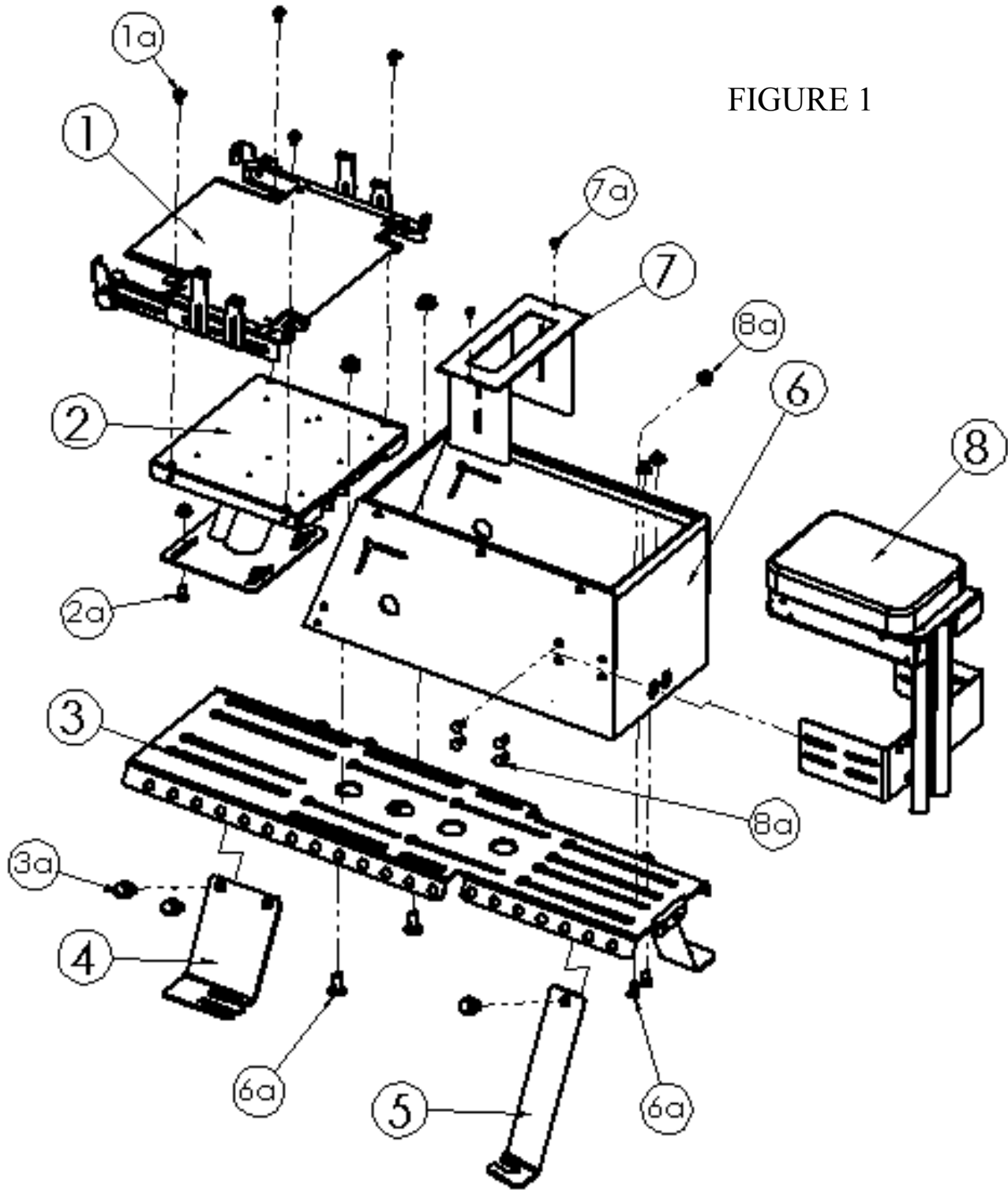

INSTALLATION

Install 4 carriage bolts up through the Laptop Stand (2) and install washer and Nyloc nut on each (loosely). See figure 1; 2a. Slide the Laptop Stand over the slots in the floor plate with the bolt heads falling through and sliding under the floor plate. Tighten the nuts to secure its position.

WARRANTY

D & R Electronics warrants its new products to be free from defects in material and workmanship, under normal use and service for a period of one year on parts replacement and one year on labor.

This warranty applies only to original purchasers acquiring the product directly from D&R Electronics, or its authorized dealers. Warranty will not be recognized without proof of purchase or bill of sale.

This warranty is not transferable.

The warranty begins on the date of delivery to the first user/purchaser.

This warranty shall not apply to products which must be repaired due to normal wear and tear, negligence, improper installation, abuse, misuse, or which have been altered or modified at a facility other than D & R Electronics, or its authorized depot centers.

Units proved to be defective within the warranty period, based on an examination by D&R Electronics, will be replaced or repaired at D & R Electronics' option. This warranty does not cover travel expenses or labor charges for removal or installation.

Lamps, flash tubes, batteries or other items considered consumables are not covered under warranty.

This warranty is in lieu of all other express warranties. D&R Electronics makes no warranties, expressed or implied, other than the express warranties contained herein.

PRODUCT RETURN POLICY

In order to provide you with faster service, product returns for repair or replacement, must have a **Return Goods Authorization Number (RGA number)**. Please contact our company to obtain a RGA number before you return the product to D & R ELECTRONICS.

Write the RGA number clearly on the package. Be sure you use sufficient packing materials to avoid damage to the product being returned while in transit.

D & R ELECTRONICS assumes no responsibility or liability for expenses incurred for the removal and/or the installation of products requiring service and/or repair.

D&R ELECTRONICS Co. LTD.

CANADA

USA

8820 George Bolton Pkwy.
Bolton, Ontario L7E 2Y4

4500 Witmer Industrial Estates
Niagara Falls, NY, 14305-1386

Tel.: (905)951-9997
Fax: (905)951-0019

Toll Free 1-800-538-7338

www.dandrelectronics.com