

REV.	DESCRIPTION	BY	DATE	APPROVED

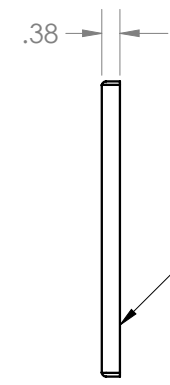
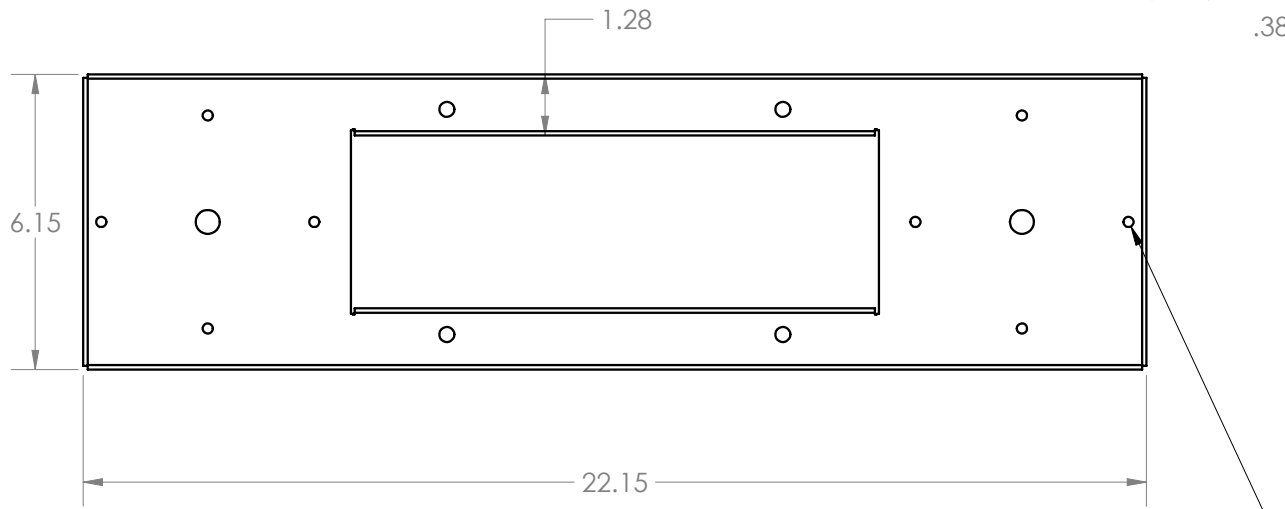

INSTALL RUBBER U-CHANNEL (825-351). CUT LENGTH TO FIT EACH EDGE (22", 11" and 6.15" APPROX.)

PEM SO-632-8-ZI 8X (After Paint)

PAN HD SCREW, #6 x 1/2" #6 FLAT & LOCK WASHER 4X

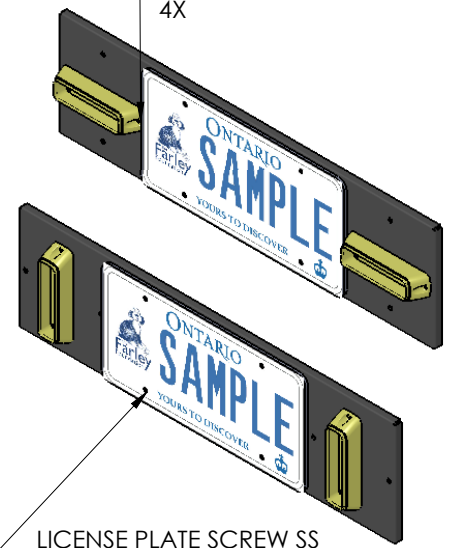

LICENSE PLATE SCREW SS #14 x 1" (411-0135) 4X

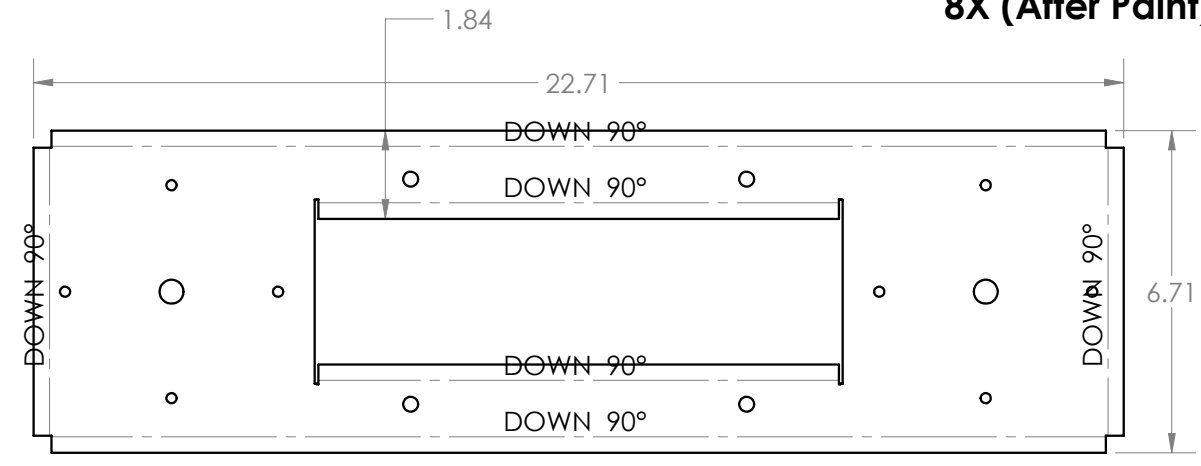

FLAT PATTERN

BAG HARDWARE:
4x PAN HD SCREW #6 x 1/2" SS (401-0103)
4x FLAT WASHER #6 SS (403-0109)
4x LOCK WASHER #6 SS (403-0045)
4x LICENSE PLATE SCREW SS #14 x 1"(411-0135)

DRAWN	AT	25AUG15	ELECTRONICS CO., LTD. Path: \\server-file\data\M\MECH_DATA\936 Brackets\936-0533B Genesis License Plate Brkt File: 936-0533B Date: Monday, October 05, 2015 8:28:55 AM	DANDR-ANSI-A REV2 APRIL 1, 2009	SIZE A
CHECKED	AD	25AUG15		DESCRIPTION: Genesis License Plate Brkt 2 Lights	MFG. NO. 936-0533B
THE INFORMATION CONTAINED WITHIN THIS DRAWING IS PROPRIETARY AND CONFIDENTIAL. AND IS THE SOLE PROPERTY OF DANDR ELECTRONICS CO. LTD. IT MAY NOT BE REPRODUCED AT WHOLE OR IN PART WITHOUT THE WRITTEN PERMISSION OF DANDR ELECTRONICS CO. LTD.			USED ON: 9XX-XXXX	SHEET 1 OF 1	
FINISH	ZINC PLATE + PAINT EXT SEMI-GLOSS BLACK		MATERIAL 14ga CRS	REV.	0