



GENESIS LED LIGHT

GT2S12-X



- ▶ These compact modules provide great versatility for a wide range of mounting
- ▶ Surface, Flush or Deck mount LED flashing modules
- ▶ All modules are gasket sealed, waterproof for external mounting applications
- ▶ Multiple flash patterns built-in
- ▶ Synchronous or alternate operation
- ▶ Each module has 12 led
- ▶ Input Voltage: 12-24 VDC Nominal
- ▶ Meets SAE Class 1 Standards
- ▶ Available colors:
 - Single colors:
 - Dual colors:

GT2D12-X

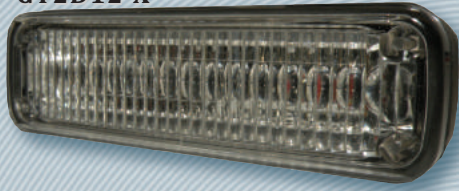

GT2F12-X



AVAILABLE BRACKETS

(Must use the GTD Lights for the following brackets)

- 936-0518A - Double Stacked DRCS110 Mount
- 936-0521A - Surface Mount L Bracket, 2" Tall
- 936-0522A - Surface Mount L Bracket, 4" Tall
- 936-0523A - Surface Mount L Bracket, 2" Tall Double
- 936-0524A - Surface Mount L Bracket, 4" Tall Double
- 936-0525A - Surface Mount L Bracket, 2 Units Stacked

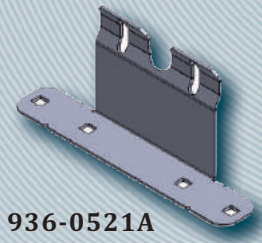

936-0521A

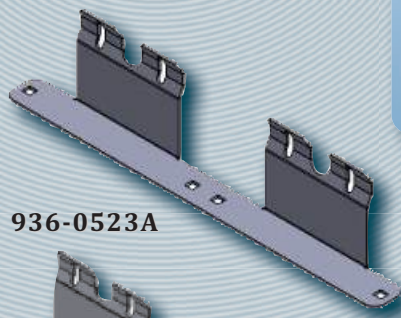

936-0523A

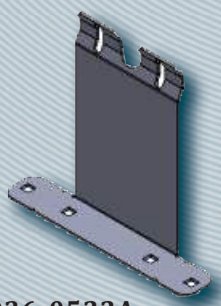

936-0522A

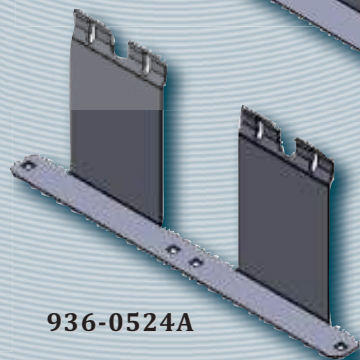

936-0524A



936-0525A

www.dandreelectronics.com





LED LIGHTS

www.dandreelectronics.com

GENESIS LED LIGHT DIMENSIONS

GT2D12-X

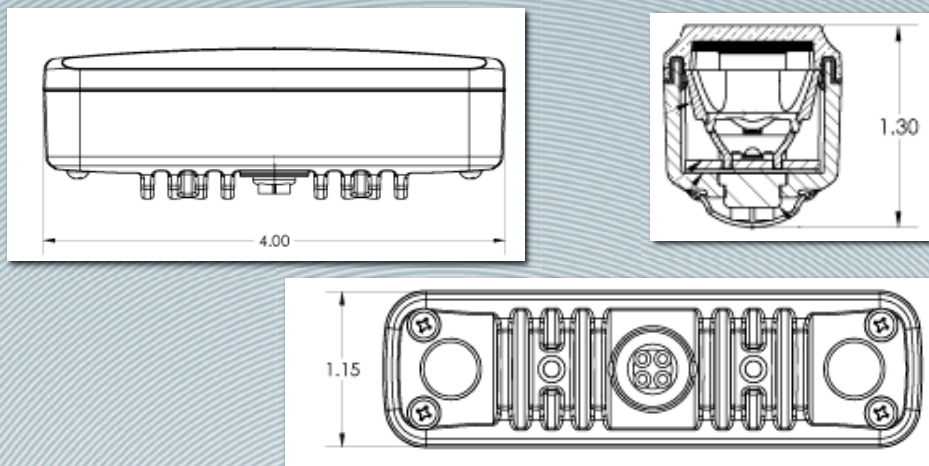

GT2F12-X

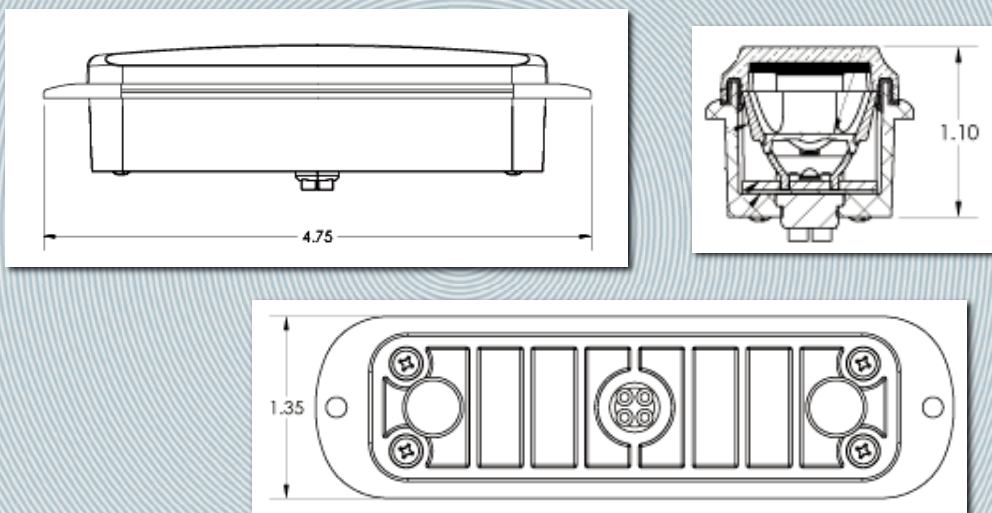

GT2S12-X

