

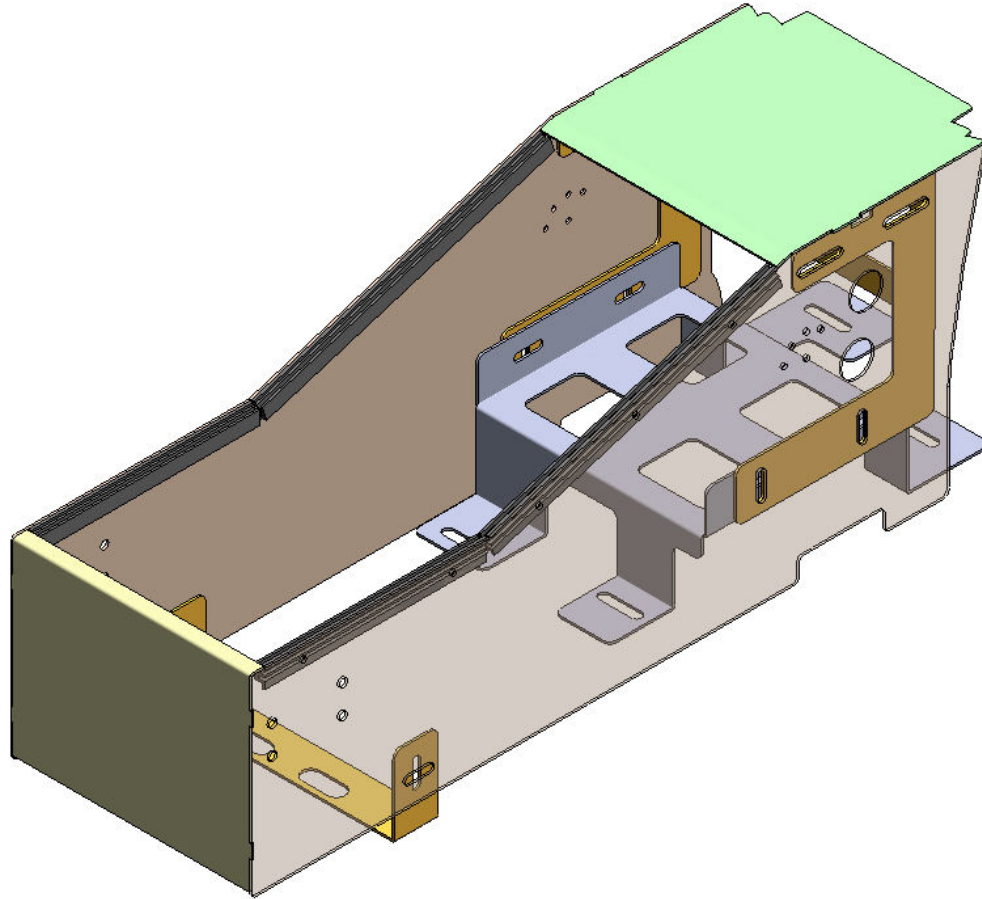

**CONSOLE
FORD INTERCEPTOR UTILITY (EXPLORER) 2013
901-0087**

Installation Instructions



Parts List

Part #	Description	Qty
901-0087A	EXPLORER INTERCEPTOR LT7600 CONSOLE	1
801-0428A	FRONT MOUNTING BRACKET	1
801-0429A	BACK MOUNTING BRACKET	1

Hardware List

Line #	Description	Qty
1	BOLT CARRIAGE 1/4-20 X 5/8"	6
2	WASHER 1/4"	6
3	NUT NYLOCK 1/4"	6
4	# 6 TAP SCREW BLACK FOR FACEPLATES	10

Installation Instructions

Step 1
Remove the factory side panels and then remove lower dash section by loosening 2 Screws on either side.



Step 2

Remove 2x (12v) sockets from removed dash panel and re-install on the passenger side of the new console. Note that the metal part of the socket has been separated for easy install.



CAUTION: DO NOT hammer or force the plastic covers. They have a pin on each side, that must be pressed using a small flat-head screwdriver when installing.

Step 3

Remove Console Area Factory Floor Plate by removing 2 bolts located under the dash, 2 inside the cutouts on top of the plate and 2 bolts on the back side of the plate. Retain hardware for new console.

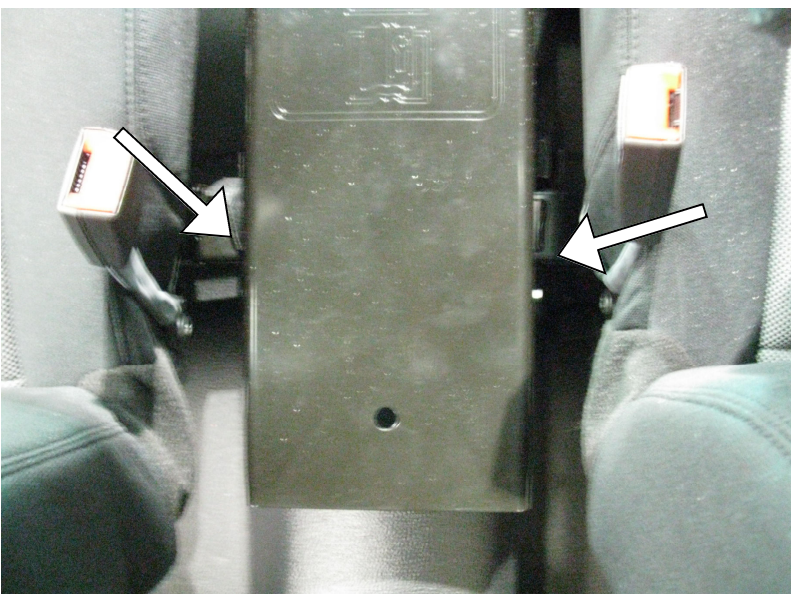

Step 4

Attach lower dash part back in. Run the harness and 2x (12v) sockets connectors through. Bolt this back in place with the 2 bolts removed from step 2.



Step 5

Lift the Carpet located between the front seat belt locks. Remove the 2 nuts on the floor, and mount the rear console bracket. Center bracket and tighten nuts.



Step 6

Mount the front console bracket using bolts removed in Step 3. Using the console as reference, center the bracket and tighten the bolts.

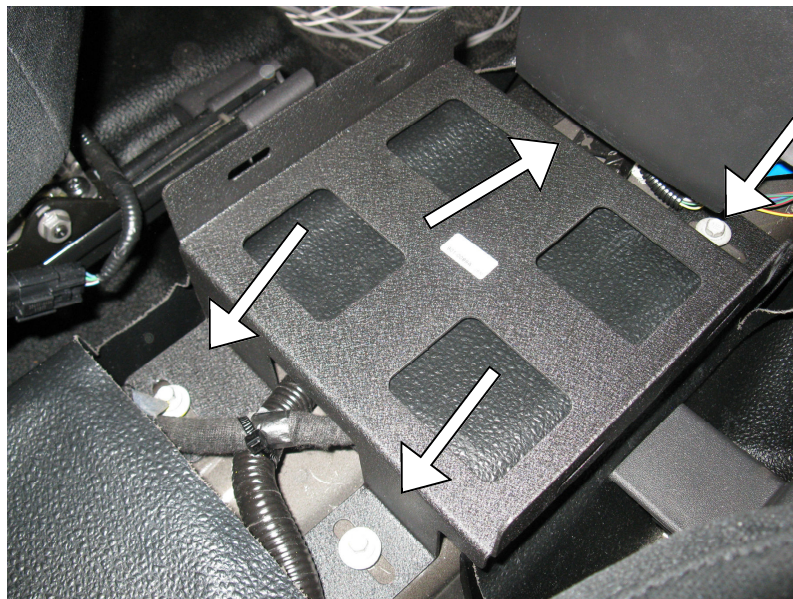

Step 7

Attached dash side panels and place console on mounting brackets, connect the 12v sockets.

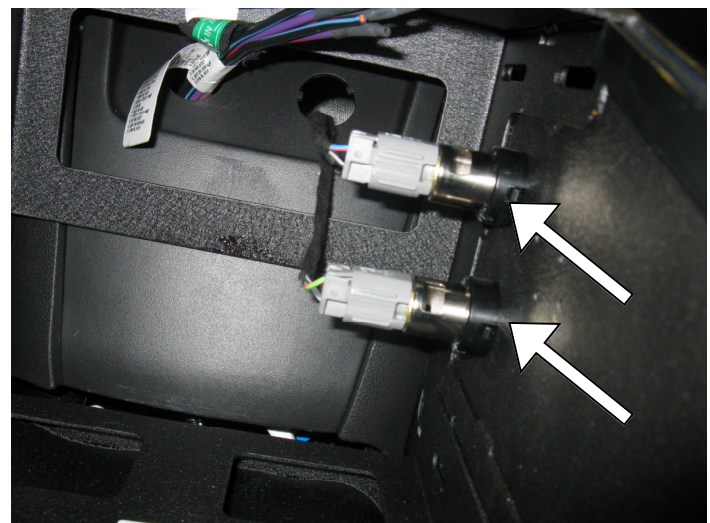

Step 8

Attach console to both, front and back, mounting brackets using supplied hardware.

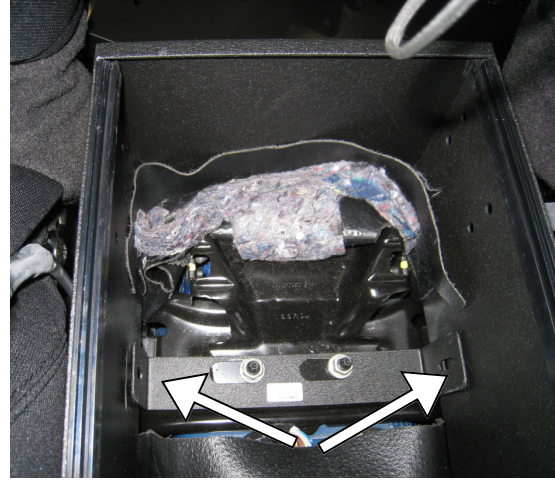
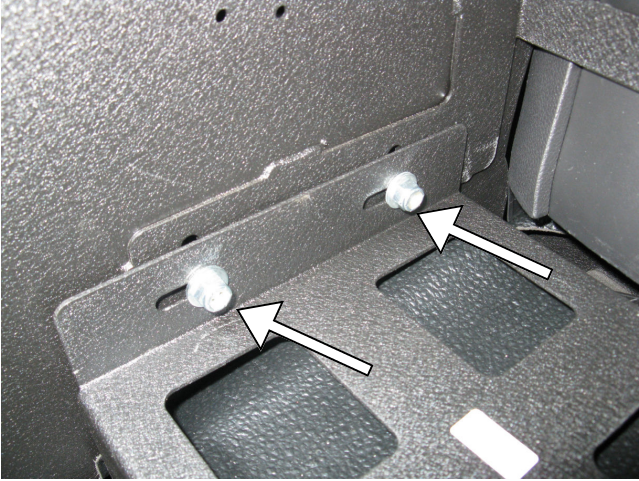

Step 9

Slide console forward tight to dash and tighten the 4 front bolt and the 2 rear bolts.



WARRANTY

D & R Electronics warrants its new products to be free from defects in material and workmanship, under normal use and service, for a period of one year on parts replacement, and one year on labor. This warranty applies only to original purchasers acquiring the product directly from D&R Electronics, or its authorized dealers. Warranty will not be recognized without proof of purchase or bill of sale. This warranty is not transferable. The warranty begins on the date of delivery to the first user/purchaser. This warranty shall not apply to products which must be repaired due to normal wear and tear, negligence, improper installation, abuse, misuse, or which have been altered or modified at a facility other than D & R Electronics, or its authorized depot center. Units proved to be defective within the warranty period, based on an examination by D&R Electronics, will be replaced or repaired at D & R Electronics' option. This warranty does not cover travel expenses or labor charges for removal or installation. Lamps, flash tubes, batteries or other items considered consumables are not covered under warranty. This warranty is in lieu of all other express warranties. D&R Electronics makes no other warranties, expressed or implied, than the express warranties contained herein.

PRODUCT RETURN POLICY

In order to provide you with faster service, product returns for repair or replacement, must have a **Return Goods Authorization Number (RGA number)**. Please contact our company to obtain a RGA number before you return the product to D & R ELECTRONICS. Write the RGA number clearly on the package. Be sure you use sufficient packing materials to avoid damage to the product being returned while in transit. D & R ELECTRONICS assumes no responsibility or liability for expenses incurred for the removal and/or the installation

D&R ELECTRONICS Co. LTD

8820 George Bolton Pkwy.
Bolton, Ontario L7E 2Y4 CANADA
Tel.: (905)951-9997 Fax: (905)951-0019
Toll Free 1-800-538-7338
www.dandrelectronics.com

2299 Kenmore Ave.
Building #3, Doors 11-14
Buffalo, NY 14207
USA